

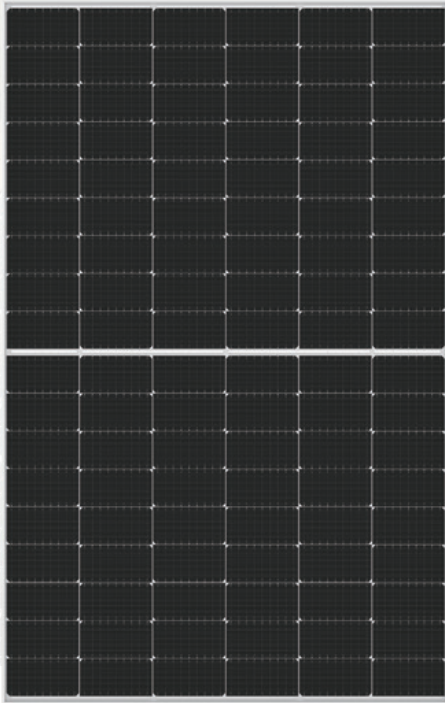

HIGH PERFORMANCE MONOCRYSTALLINE PERC MODULE

ASM108-9-405M-425M



108 CELL Mono PERC Module	405M-425Wp Power Output Range
1500VDC Maximum System Voltage	21.8% Maximum Efficiency

KEY SALIENT FEATURES

-  Global, Tier 1 manufacturer brand, with independently certified state-of-the-art automated manufacturing
-  Industry leading lowest thermal co-efficient of power
-  Excellent low irradiance performance
-  Excellent PID resistance
-  Dual stage 100% EL Inspection warranting defect-free product
-  Module Imp binning radically reduces string mismatch losses
-  Excellent wind load 2400Pa & snow load 5400Pa under certain installation method
-  Comprehensive product and system certification
 - ◆ IEC61215:2016; IEC61730-1/-2:2016;
 - ◆ ISO 9001:2015 Quality Management System
 - ◆ ISO 14001:2015 Environmental Management System
 - ◆ ISO 45001:2018 Occupational Health and Safety Management System



LINEAR PERFORMANCE WARRANTY

12 Year Product Warranty / 25 year Linear Power Warranty

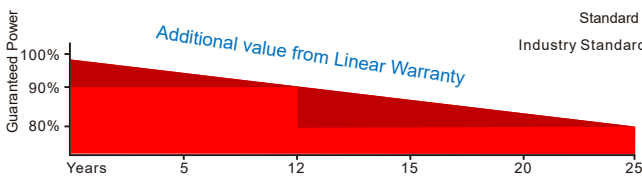

TEL:+ 86 18861020818

WEB:www.alicosolar.com

E-mail:sales01 @alicosolar.com

Jingjiang Alicosolar New Energy Co., Ltd.

ADD:No. 11, Fuyang Road, Taizhou, Jingsu, China

Dimensions of PV Module

Unit: mm

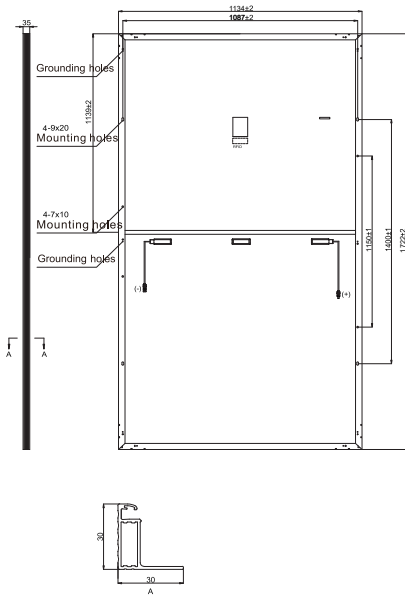

ELECTRICAL DATA(STC)

Model Number	ASM108-9-405M	ASM108-9-410M	ASM108-9-415M	ASM108-9-420M	ASM108-9-425M
Rated Power in Watts-Pmax(Wp)	405	410	415	420	425
Open Circuit Voltage-Voc(V)	37.00	37.25	37.50	37.75	37.96
Short Circuit Current-Isc(A)	13.83	13.88	13.94	14.01	14.08
Maximum Power Voltage-Vmpp(V)	31.0	31.25	31.49	31.73	31.94
Maximum Power Current-Impp(A)	13.07	13.12	13.18	13.24	13.31
Module Efficiency (%) *	20.7	21.0	21.3	21.5	21.8

STC: Irradiance 1000 W/m², Cell Temperature 25°C, Air Mass AM1.5 according to EN 60904-3.

* Module Efficiency (%): Round-off to the nearest number

ELECTRICAL DATA(NMOT)

Model Number	ASM108-9-405M	ASM108-9-410M	ASM108-9-415M	ASM108-9-420M	ASM108-9-425M
Maximum Power-Pmax (Wp)	302.7	306.5	310.2	313.9	317.7
Open Circuit Voltage-Voc (V)	34.79	35.02	35.26	35.49	35.69
Short Circuit Current-Isc (A)	11.18	11.22	11.27	11.32	11.38
Maximum Power Voltage-Vmpp (V)	28.80	29.03	29.25	29.47	29.67
Maximum Power Current-Impp (A)	10.52	10.56	10.60	10.65	10.71

NMOT: Irradiance at 800 W/m², Ambient Temperature 20°C, Wind Speed 1 m/s.

MECHANICAL DATA

Solar cells	Monocrystalline
Cell configuration	108 cells (6×18)
Module dimensions	1722×1134×30mm
Weight	22 kg
Superstrate	High Transmission, Low Iron, Tempered ARC Glass
Substrate	White Back-sheet
Frame	Anodized Aluminium Alloy type 6005-2T6, Silver Color
J-Box	Potted, IP68, 1500VDC, 3 Schottky bypass diodes
Cables	4.0mm ² (12AWG), Positive(+)350mm, Negative(-)230mm (Connector Included)
Connector	PV-SY02, IP68

TEMPERATURE&MAXIMUM RATINGS

Nominal Module Operating Temperature (NMOT)	45°C±2°C
Temperature Coefficient of Voc	-0.265%/°C
Temperature Coefficient of Isc	0.05%/°C
Temperature Coefficient of Pmax	-0.34%/°C
Operational Temperature	-40°C~+85°C
Maximum System Voltage	1500VDC
Max Series Fuse Rating	25A
Limiting Reverse Current	25A

PACKAGING CONFIGURATION

	40ft(HQ)Aluminum Frame	20ft(HQ)Aluminum Frame
Number of modules per container	936	216
Number of modules per pallet	36	36
Number of pallets per container	26	6
Packaging box dimensions (LxWxH) in mm	1750×1115×1260	1750×1115×1260
Box gross weight[kg]	810	810

